

BRINE TANK WITH LID IB-BTD (60 – 1.000 liters)

- **Tank with lid:** made of UV-stabilized polyethylene - food safe
- Color: natural transparent (blue version on request)
- Seamlessly manufactured in rotational moulding process cylindrical standing container with lid shock and impact resistant
- Molded-in liter scale flat spot for mounting of fittings
- Medium density 1.1 kg/dm³ (higher density on request)

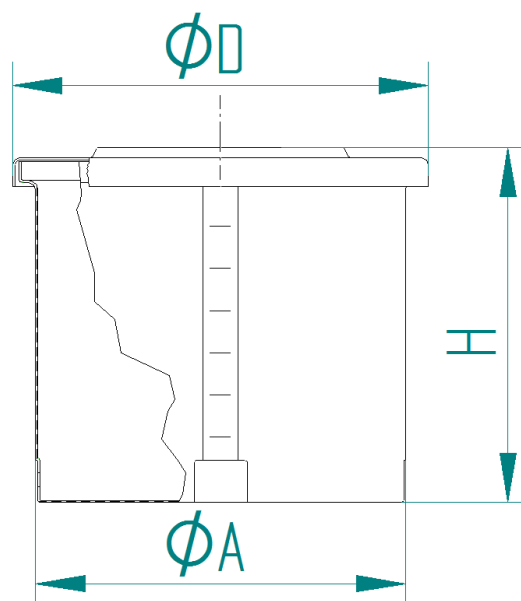

Order No.	Article No.	Capacity (liters)	Outer-Ø A (mm)	Lid-Ø D (mm)	Height H (mm)	Weight approx. (kg)
IB-BTD00060	1-210.17.006	60	410	470	540	5
IB-BTD00100	1-210.17.010	100	440	500	720	7
IB-BTD00200	1-210.17.020	200	545	630	940	12
IB-BTD00300	1-210.17.030	300	645	730	960	16
IB-BTD00400	1-210.17.040	400	760	870	960	20
IB-BTD00500	1-210.17.050	500	845	950	965	25
IB-BTD00750	1-210.17.075	750	1050	1160	960	35
IB-BTD01000	1-210.17.100	1000	1140	1260	1070	46



Tender specification IB-BTD (60 – 1.000 liters)

Tank with lid made of UV-stabilized polyethylene (PE) - food safe as well as shock and impact resistant.
Cylindrical, upright container seamlessly manufactured in rotational moulding process.
Flat spot for mounting of fittings and molded-in liter scale.
Color: natural transparent (blue version on request).
Medium density 1,1 kg/dm³ (higher density on request)

Capacity: l

Height:..... mm

Outer Ø: mm

Lid-Ø: mm

Part number:

Special version:

Color: